

Near Field Probe

500 to 750 GHz, WR1.5

DESCRIPTION

The NFP-15-WR1.5 is a high-performance open-ended waveguide probe that operates between 500 and 750 GHz. It is manufactured in split-block configuration by high accurate manufacturing processes. The sharp edge is converted to a conical shape to scatter reflections.

All NFPs can include adequate absorber material to reduce backscattering reflections from flanges.

APPLICATIONS

This type of horns is especially suitable for laboratory test measurements, electromagnetic measurements and gain calibration. Moreover, custom bands and gain values can be requested.

Anteral also offers their **CATR** (Compact Antennas Test Range) for measuring large antennas at significant short ranges in antenna test facilities.

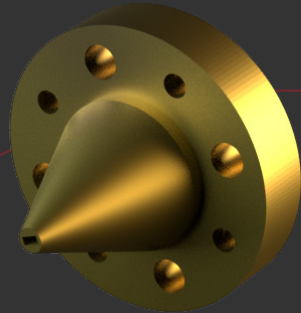

ELECTRICAL SPECIFICATIONS

Parameter	Minimum	Typical	Maximum
Frequency	500 GHz	625 GHz	750 GHz
Gain		7.5 dBi	
S11		-13 dB	

MECHANICAL SPECIFICATIONS

Parameter	Description
Antenna Port	WR-1.5 (0.380 mm x 0.190 mm)
Flange	UG-387/U
Total length	15 mm
Horn Material	Aluminum

MECHANICAL OUTLINE

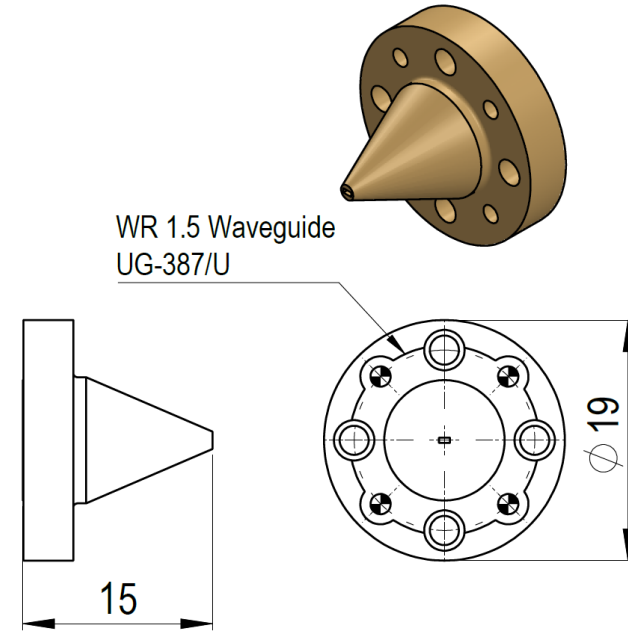

Additional notes

The return loss performance of all items is checked before delivery.