

Near Field Probe

400 to 600 GHz, WR1.9

DESCRIPTION

The NFP-15-WR1.9 is a high-performance open-ended waveguide probe that operates between 400 and 600 GHz. It is manufactured in split-block configuration by high accurate manufacturing processes. The sharp edge is converted to a conical shape to scatter reflections.

All NFPs can include adequate absorber material to reduce backscattering reflections from flanges.

APPLICATIONS

This type of horns is especially suitable for laboratory test measurements, electromagnetic measurements and gain calibration. Moreover, custom bands and gain values can be requested.

Anteral also offers their **CATR** (Compact Antennas Test Range) for measuring large antennas at significant short ranges in antenna test facilities.

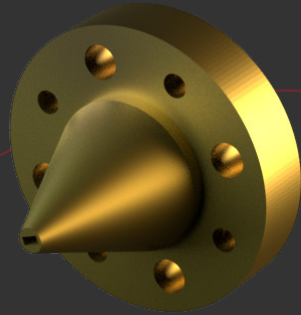

ELECTRICAL SPECIFICATIONS

| Parameter | Minimum | Typical | Maximum |
|-----------|---------|---------|---------|
| Frequency | 400 GHz | 500 GHz | 600 GHz |
| Gain | | 7.5 dBi | |
| S11 | | -13 dB | |

MECHANICAL SPECIFICATIONS

| Parameter | Description |
|---------------|------------------------------|
| Antenna Port | WR-1.9 (0.470 mm x 0.235 mm) |
| Flange | UG-387/U |
| Total length | 15 mm |
| Horn Material | Aluminum |

MECHANICAL OUTLINE

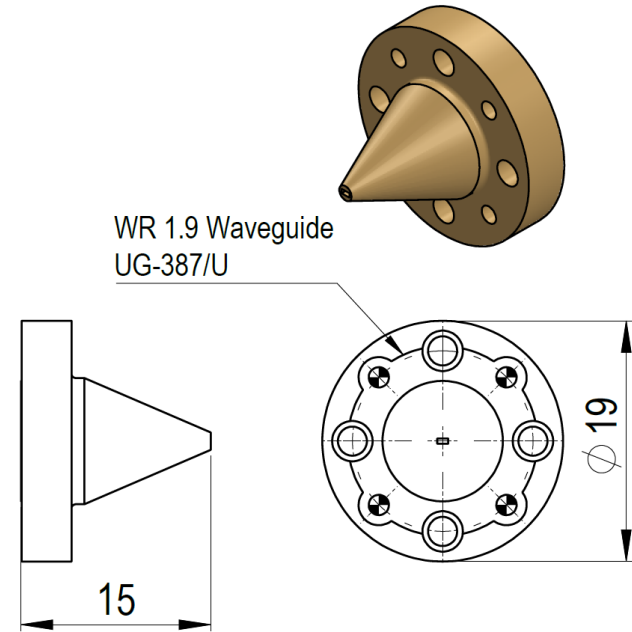

Additional notes

The return loss performance of all items is checked before delivery.