

# Near Field Probe

260 to 400 GHz, WR2.8

## DESCRIPTION

The NFP-15-WR2.8 is a high-performance open-ended waveguide probe that operates between 260 and 400 GHz. It is manufactured in split-block configuration by high accurate manufacturing processes. The sharp edge is converted to a conical shape to scatter reflections.

All NFPs can include adequate absorber material to reduce backscattering reflections from flanges.

## APPLICATIONS

This type of horns is especially suitable for laboratory test measurements, electromagnetic measurements and gain calibration. Moreover, custom bands and gain values can be requested.

Anteral also offers their **CATR** (Compact Antennas Test Range) for measuring large antennas at significant short ranges in antenna test facilities.

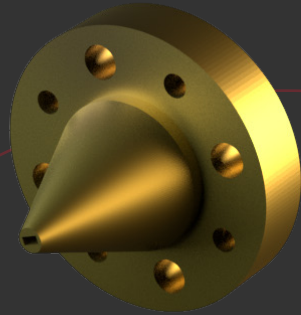

### ELECTRICAL SPECIFICATIONS

Parameter	Minimum	Typical	Maximum
Frequency	260 GHz	330 GHz	400 GHz
Gain		7.5 dBi	
S11		-13 dB	

### MECHANICAL SPECIFICATIONS

Parameter	Description
Antenna Port	WR-2.8 (0.710 mm x 0.356 mm)
Flange	UG-387/U
Total length	15 mm
Horn Material	Aluminum

### MECHANICAL OUTLINE

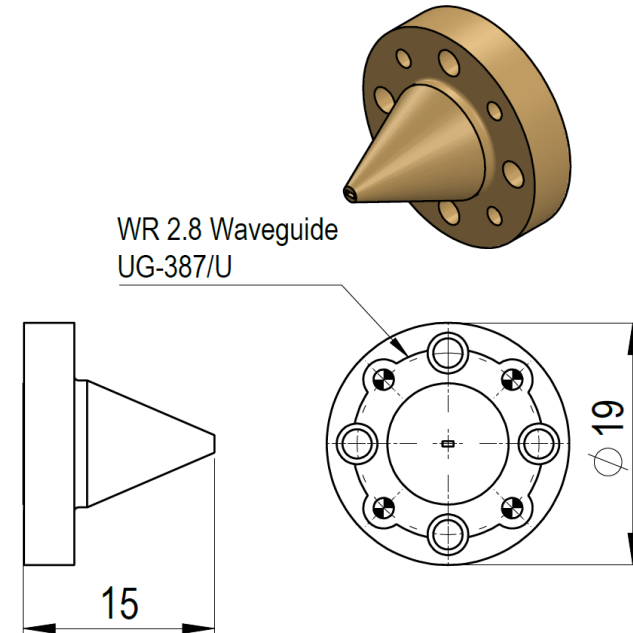

### Additional notes

The return loss performance of all items is checked before delivery.